

# BLUE STAR FARM

Boarding, Training and Horse Show Facility  
Hunters / Jumpers / Dressage



## 2017 Blue Star Farm's Trilogy Combined Test Competition A Skills Development Series Competition

**May 14<sup>th</sup>**

Judges – Rene Huyge and Jane Heatherington

Show Secretary – Sandra Keene, Cameron Edwards

Course Designer – Lynne Sproule

Announcer – Paul Hillier

In-gates: Dressage - Linda Weldon, Jumper – Sarah Tackaberry

Ring Crew – John McLean, Adam Malany, Peter Sanders, Matt Legros

Closing Date – May 7<sup>th</sup>



### Other Trilogy Dates

Saturday July 1	Unicorn Farm
Sunday July 30	Lane's End Stables
Saturday, August 12	Small Victory Farm
Sunday, August 27	Sunnymead Farm

Please note that the NEW 2016 National Eventing Tests will be used as identified at <http://equinecanada.ca/dressage>.

**Show Office Open 7:00 am**

**First Class at 8:00 am**

The Trilogy horse show is covered under OEF as Skills Development Series Competition. All other shows in the 2017 Blue Star Farm series are recognized member competitions of Equine Canada (EC), 308 Leggett Drive, Kanata, Ontario K2K 1Y6 and are governed by the rules of EC.



---

## DIVISIONS & CLASS LIST

---

All competitors must have a current membership with the Ontario Equestrian Federation. Please provide a photocopy of the Membership Card with entry form.

All competitors must also have a current 2017 Trilogy membership. Please refer to the membership application and either submit prior to the show or with the entry form.

Ring Size for all tests will be set at 20m x 40m

Grasshopper Division	Cadora, W/T Test "A" Stadium Crossrails – Maximum height 18"	Open/Jr
Novice Division	Eventing Entry Test #1 Stadium – maximum height 2'	Open/Jr
Pre-Entry Division	Eventing Entry Test #1 Stadium maximum height 2'6"	Open
Entry Division	Eventing Entry Test #2 Stadium – maximum height 2'9"	Open
Pre-Training Division	Eventing Pre-Training Test #1 Stadium - Maximum height 3'	Open

Sponsors for the divisions:

Grasshopper Junior - Victoria Feeds/Horse and Hound

Grasshopper Open – Competitive Edge Horseshoeing

Novice Junior – Keralot Equestrian Supplies and Gifts

Novice Open – Marc Campbell Farrier Services

Pre-Entry Junior – Greenhawk Peterborough

Entry Peterborough Tack

Pre-Training – Bahr's Saddlery

Dressage Only rounds-Royal Repairs

All divisions – Village Pet Food Supply and HH Goode & Son Agricultural Supplies

All Divisions – Blue Star Farm



---

## ENTRY FEES

---

Division	\$50.00
Stadium Only	\$20.00
Dressage Only	\$30.00
Administration Fee	\$15.00
Late Fee (entries received after closing date)	\$25.00
NSF Fee	\$45.00
Trilogy membership	\$15.00
HST applied to all fees with exception of the Trilogy membership - #124935214RT0001	

### **Entries and Cancellation Policy**

Competitors may enter dressage only, stadium only or the division.

Completed entry forms and payment must be mailed to the host show prior to the closing date for the show.

Post-dated cheques will not be accepted. Closing dates are one week prior to each show. Entries received after the closing date will be charged an additional \$25.00 late entry fee.

**Show management has the right to refuse any entry.**

No refunds will be issued after the closing date unless a Veterinary/Doctor's certificate is provided to show management

NSF cheques will incur a \$45.00 processing fee

---

## STABLING

---

<b>FEES</b>	Day Stall	\$25.00	per show day
	Overnight Stall	\$50.00	per 24 hour period
	Tack Stall	\$25.00	per show day ( <i>availability to be confirmed</i> )
	Hay / Shavings	\$ 7.00	per bale

Limited stabling is available on the day of the show on a first reserved basis and should be booked in advance. We will not accept stable requests unless accompanied by an Entry Form. "Day" stalls must be vacated by end of show day. If a cancellation is received, every effort will be made to resell the stall. A refund will only be made available if we are able to resell the stall.

Please ensure to bring your own buckets.

DAY STALLS MUST BE VACATED BY 8:00 PM DAY OF SHOW OTHERWISE THE OVERNIGHT FEE WILL BE CHARGED.

A list of stall assignments will be posted on our website. Please ensure that you check our website at [www.bluestarfarm.com](http://www.bluestarfarm.com).



---

## EQUIPMENT AND DRESS

---

All competitors must wear ASTM or SEI approved helmet with safety harness at all times while mounted anywhere on show grounds. Any rider competing in a Trilogy competition is permitted to wear a safety vest.

Appearance must be neat and clean with all riders in show jacket, breeches and riding boots or paddock boots and half chaps of a conservative colour. In the event of inclement or excessively hot/humid weather, show management will make appropriate allowances. Spurs without rowels are permitted

**Dressage test:** Horses shall wear a snaffle bridle with a smooth mouthpiece (i.e. twisted and roller bits are prohibited) with ring, egg-butt or bar type cheeks. The bit may be made of metal, rubber or synthetic material. Whips no longer than 120 cm (47") including lash may be carried when riding in dressage warm-up and the dressage test. There will be a tack check for each competitor prior to the dressage test.

**Jumping test:** Whips no longer than 75 cm (30") are permitted, as are running martingales, jumping boots or bandages, fly shields for ears only, hackamores or gags.

---

## THE JUMPING TEST

---

**FALLS:** The first fall of competitor or horse will result in elimination from their current class. A competitor is considered to have fallen when he/she is separated from their horse in such a way as to necessitate remounting. Where a rider falls, they are not permitted to remount in the ring. A horse is considered to have fallen when its shoulders and haunches have touched the ground at the same time. A rider who has fallen must be checked by a qualified professional who is in attendance at the show

This test is similar to an ordinary show jumping competition. In this series, this **class will be timed at the Pre-Entry, Entry and Pre-Training levels** to determine the placing of each competitor in the jumping test. **Riders will receive time penalties as per eventing rules for unnecessarily slow rounds.**

**At the Grasshopper and Novice levels**, where clear rounds occur, the judge will determine placing based on performance (ie) style, smoothness of round.

The judge must be saluted prior to starting the round.

After the signal to start, competitors should cross the starting line within 45 seconds. Should a competitor be eliminated during their round, they will be signaled to stop, and must leave the course at that time.

**Stadium Speeds for each of the levels are as follows:**

Pre-Entry and Entry – 300m/min

Pre-Training – 325m/min

Courses will have distances and optimum times posted on course maps. Start and finish points will be marked.

### UNAUTHORIZED ASSISTANCE

**Any outside intervention by voice, signs (except where dressage test is called), is considered as assistance to the rider or horse. Any such help given to a mounted competitor between the start signal and crossing the finish line will be penalized by elimination of the competitor.**

All competitors may do a second or "schooling" round immediately if the rider wishes, and they may be assisted by their coach in the ring at this time. Only the first round will count towards the rider's score in the division. Competitors must notify the judge that they intend to ride a second round prior to starting.



---

## SCORING

---

Dressage Scoring: The good marks from 0-10 awarded by the judge for each numbered movement of the dressage test are added together with the collective marks, and any errors deducted. **Half marks are permitted.** This is expressed as a percentage of the maximum possible good marks for each test. This percentage will be used to determine the placing of each competitor in the dressage portion of each division.

Where there is only one entry in the class, the rider's placing will be according to the following scale:

- 1<sup>st</sup> place 60% or higher
- 2<sup>nd</sup> place 57-59.9%
- 3<sup>rd</sup> place 54-56.9%
- 4<sup>th</sup> place 51-53.9%.

The percentage is converted to penalty points by subtracting from 100 and multiplying by 1.5. For example: the dressage score is 70%. Expressed as penalty points it would be  $100 - 70 = 30 \times 1.5 = 45$  penalty points.

No ribbons/prizes will be awarded below 4<sup>th</sup> place.

Penalty points are added with the penalty points accrued in the jumping test to determine the overall placing in the division.

Jumping faults:

- |                                      |             |
|--------------------------------------|-------------|
| ▪ Knocking down an obstacle          | 4 penalties |
| ▪ First disobedience                 | 4 penalties |
| ▪ Second disobedience                | 8 penalties |
| ▪ Third disobedience                 | elimination |
| ▪ Fall of horse or rider             | elimination |
| ▪ Omitting an obstacle               | elimination |
| ▪ Not crossing start or finish lines | elimination |

Disobediences are defined as a refusal, or run out.

A *refusal* occurs when a horse stops in front of an obstacle to be jumped, and steps back in any way. A stop followed immediately by a standing jump is not penalized, but if the halt is in any way prolonged, this constitutes a refusal.

A *run-out* occurs when a horse is presented to the obstacle and avoids the obstacle.

Time penalties will be applied for exceeding the time allowed at the Pre-Entry, Entry and Pre-Training levels. For each second or part second over the time allowed, riders will accrue  $\frac{1}{4}$  time penalty. Riders who exceed the time limit (twice the time allowed) will be eliminated. Completing the course in less than the time allowed is not rewarded.



---

## WHILE AT BLUE STAR FARM ...

---

We respectfully ask that you observe the following considerations while on our property to ensure the safety, well-being and enjoyment of all spectators and competitors –

- All riders must wear appropriate headgear at all times while mounted.
- Non-showing horses must register and display a number at all times
- If you are scratching from a class, please ensure that the show office is advised as soon as possible.
- Please observe the “left-to-left” rule when passing in the arena.
- Please take home all that you’ve brought.
- All dogs and children must be under control at all times.
- Dogs must be leashed and the poop-and-scoop rule is in effect. It is not appropriate for any pet to be left in a vehicle unattended for any reason.
- Water and washrooms are provided for your convenience, so please keep these areas clean.
- Parking areas have been designated on the attached facilities map. All vehicles must park in the west field accessed from the main entrance and to the back of the farm. Please drive cautiously through the property. **Maximum speed is 10 mph on BSF Property.** Please use caution as horse and riders will be sharing this access area.
- Only officials and invalid parking is available in the central area by the arena.
- Blue Star Farm owners, management and volunteers are in no way responsible for any loss, damage or injury to animals, property or persons. Competitors and spectators are on the property at their own risk. Please do not leave unattended vehicles unlocked.
- If you have any comments or suggestions for the improvement of our show, please direct them to show management only. We welcome constructive comments.

### The BSF 2017 Show Schedule

Combined Training	May 14 <sup>th</sup>
Bronze H/J	May 28 <sup>th</sup> , July 2 <sup>nd</sup> and September 10 <sup>th</sup>
Bronze Dressage	May 21 <sup>st</sup> , July 16 <sup>th</sup> and Aug 13 <sup>th</sup>



# ON-SITE SHOW FACILITIES AT BLUE STAR FARM

Blue Star Farm is owned and operated by  
**MIKE & SHIRLEY HETHERINGTON**

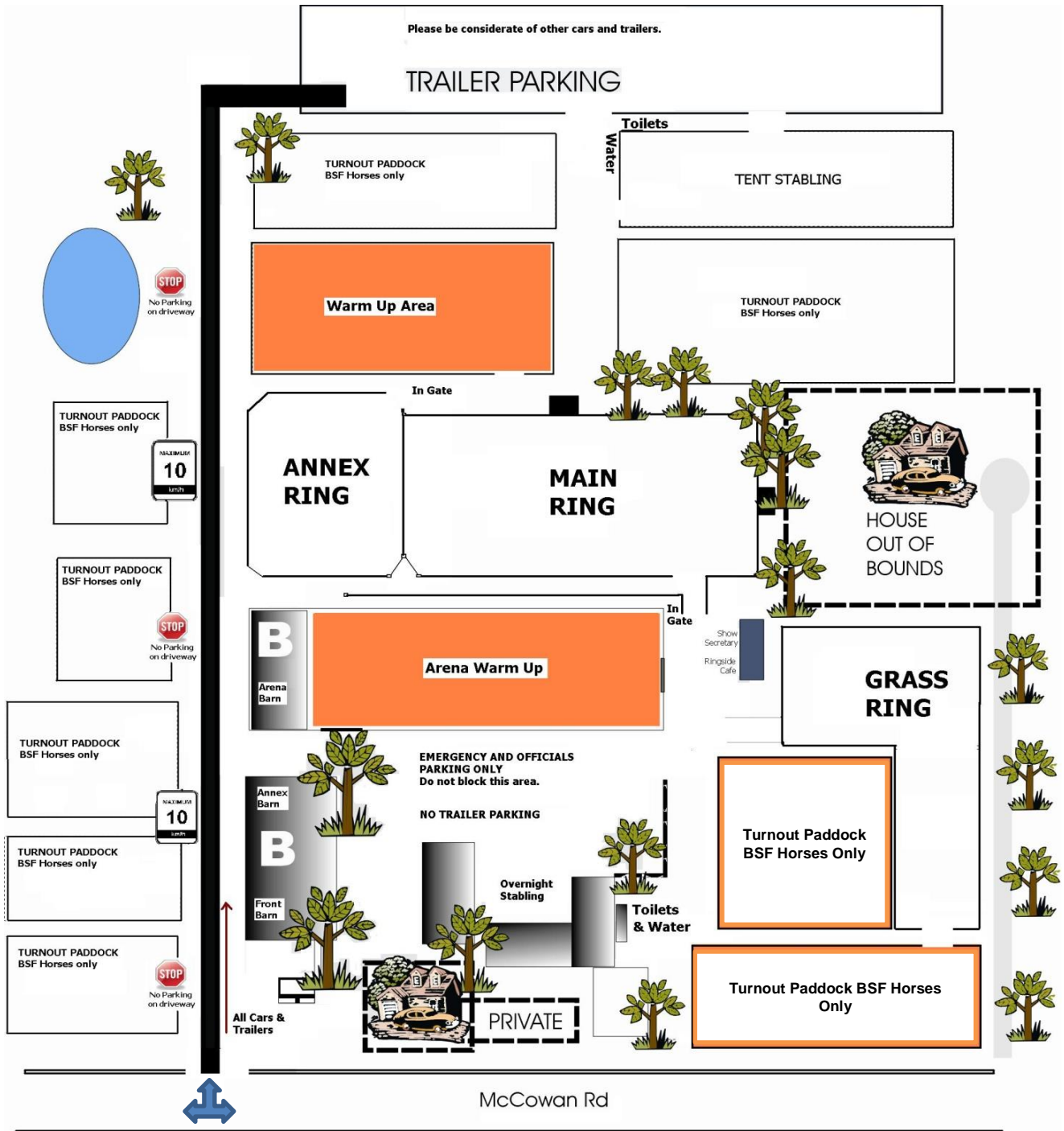

**NO PARKING ON DRIVEWAY PLEASE**  
 And for the safety of our guests and animals, please adhere to our speed limit.



For further information please contact –

**Shirley Hetherington, Show Manager**

BLUE STAR FARM  
19138 McCowan Rd

Mt. Albert, Ontario LOG IMO



**BLUE STAR**

Phone (905) 473-6045  
Fax (866) 551-5381 or (905) 473-5772  
Email [bluestarfarm@sympatico.ca](mailto:bluestarfarm@sympatico.ca)  
Web Site: [www.bluestarfarm.com](http://www.bluestarfarm.com)

BLUE STAR FARM is located on the N.W. corner of Mount Albert Road and McCowan Road in the village of Holt – 1 concession west of Hwy #48.

