

# BLUE STAR FARM

Boarding, Training and Horse Show Facility  
Hunters / Jumpers / Dressage



BLUE STAR



## 2017 HUNTER JUMPER

BRONZE Series Competitions

### Show Times

Registration 7:00am  
First Class at 8:00am

### JUMP INTO SPRING – May 28<sup>th</sup>

Judges – Heidi Mueller and Amy Knight  
Course Designer – Casey Denouden  
Steward – Marj O'Donnell  
Closing - Wed, May 24<sup>th</sup>

### Show Officials

Manager – Shirley Hetherington  
Secretary – Elaine Goldsmith  
Announcer – Paul Hillier

### SUMMER CELEBRATION – July 2<sup>nd</sup>

Judges – Jane Heatherington and Linda Weldon  
Course Designer – TBA  
Steward – Sharon Macbay  
Closing - Wed, June 28<sup>th</sup>

### Office Staff

Sarah Tackaberry  
Cameron Edwards

### AUTUMN CLASSIC– September 10<sup>th</sup>

Judges - Jane Heatherington and Linda Weldon  
Course Designer – Josh Meyer  
Steward – Marj O'Donnell

### Ring Staff

In-gate – Kelly Price et al  
Ring Crew – Adam Malany, Josh Easby,  
Matt Legros, Nick Chisholm, Eric Foote  
Scott Sedore  
Timer – John McLean

### Emergency Staff

Medic - Rob Angus  
Veterinarian – Dr. Michael Zajac (on call)  
Farrier – Barney Cummings (on call)

---

## CLASS LIST

---

### MAIN RING (Start Time 8:00 am)

#### Hack Division

1. Show Hack
2. Road Hack
3. Pleasure Hack

**NOT BEFORE 9:00 am:**

#### Baby Jumper (.60m)

19. Jumper (Table A)
20. Jumper (Table A)
21. Jumper (Table A) \* STAKE CLASS

#### Novice Jumper Division (.75m)

22. Jumper (Table A)
23. Jumper (Table A Speed)
24. Jumper (Table A) \* STAKE CLASS

#### Training Jumper Division (.90m)

25. Jumper (Table A)
26. Jumper (Table A Speed)
27. Jumper (Table A) \* STAKE CLASS

#### 1.00M Jumper Division

28. Jumper (Table A)
29. Jumper (Table A Speed)
30. Jumper (Table A) \* STAKE CLASS

\* Available on division entry only.

### ANNEX RING (Start Time 9:00 am)

#### Cross Rail Hunter

4. Open Cross Rail Warm Up
5. Cross Rail Hunter Over Fences
6. Cross Rail Hunter Over Fences
7. Cross Rail Hunter Over Fences
8. Hunter Under Saddle

#### Novice Hunter Division (2'0" / 2'3")

*Please declare height at the in-gate*

9. 2'0" Judged Warm Up
10. Hunter Over Fences
11. Hunter Over Fences
12. Hunter Over Fences \* STAKE CLASS
13. Hunter Under Saddle

#### Hi/Low Hunter Division (2'6" / 2'9")

*Please declare height at the in-gate*

14. 2'6" Judged Warm Up
15. Hunter Over Fences
16. Hunter Over Fences
17. Hunter Over Fences \* STAKE CLASS
18. Hunter Under Saddle

---

## FEES

---

Hack Division	\$60.00	
Cross Rail Division	\$65.00	
Hunter Divisions	\$70.00 *	
Jumper Divisions	\$80.00 *	
Individual Hack Classes	\$25.00	
Individual Hunter Classes	\$30.00	
Individual Jumper Classes	\$35.00	
Warm Up Rounds	\$30.00	< Hunter Divisions Only
Non Showing Horses	\$30.00	< Access to property and warm-up areas only
Medic & Admin. Fee	\$30.00	
Post Entry Fee	\$15.00 **	
Day Stall	\$60.00	
Overnight Stall	\$75.00	
Drug Fee (Bronze Level)	\$ 3.50	

HST is due at 13% with the exception of the Drug Fee and will be collected on all entries.  
#124935214

\* Stake classes, where offered, are available as Division entries only.

\*\* Closing of entries on the Wednesday immediately prior to show date.

#### Payment Options:

1. Cheque payable to BLUESTAR FARM
2. Email transfer to [bluestarfarm@sympatico.ca](mailto:bluestarfarm@sympatico.ca)
3. Cash

---

## RIBBONS AND PRIZES

---

Ribbons will be presented 1<sup>st</sup> through 8<sup>th</sup> place in each class.

Stakes class prize money to 1<sup>st</sup>, 2<sup>nd</sup> and 3<sup>rd</sup> only when there are 6 or more entries. 1<sup>st</sup> - \$50, 2<sup>nd</sup> - \$30 and 3<sup>rd</sup> - \$20.

Division & Reserve Championship ribbons will presented at each show.

### Blue Star Year End Champions

A Year End Champion and Reserve Champion will be determined by total accumulated points awarded during the 2017 BRONZE Hunter Jumper Series. All points towards a championship will be allocated to the rider who must attend all 3 shows to qualify for year end points.

---

## OFFICIAL EQUESTRIAN CANADA STATEMENT OF PRINCIPLES

---



### Statement of Principles

Equestrian Canada (EC), the national equestrian federation of Canada, supports adherence to the humane treatment of horses in all activities under its jurisdiction.

All Persons shall be committed to:

- upholding the welfare of all horses, regardless of value, as a primary consideration in all activities;
- requiring that horses be treated with kindness, respect and compassion, and that they never be subjected to mistreatment;
- ensuring that all Equestrians including owners, trainers and competitors, or their respective agents, use responsible care in the handling, treatment and transportation of their own horses as well as horses placed in their care for any purpose;
- providing for the continuous well-being of horses by encouraging routine inspection and consultation with health care professionals and competition officials to achieve the highest possible standards of nutrition, health, comfort and safety as a matter of standard operating procedure;
- providing current information on Code of Practice for the Care and Handling of Equines and other equine health and welfare initiatives;
- continuing to support scientific studies on equine health and welfare;
- requiring owners, trainers and competitors to know and follow their sanctioning organization's rules, and to work within industry regulations in all equestrian competitions; and
- actively promoting the development of and adherence to competition rules and regulations that protect the welfare of the horse.

The standard by which conduct or treatment will be measured is that which a person who is informed and experienced in generally accepted equine training and competition procedures would determine to be neither cruel, abusive, nor inhumane.

**Per Article A801**, every entry at an EC sanctioned competition shall constitute an agreement by the person responsible that the owner, lessee, trainer, manager, agent, coach, driver or rider and horse shall be subject to the EC constitution and all rules of EC and any additional rules set by the competition. It is the responsibility of all individuals participating in any capacity in EC sanctioned competitions to be knowledgeable regarding the EC constitution and the applicable rules of EC and the additional rules, if any, imposed by the competition. Do not participate in this EC sanctioned competition in any capacity if you do not consent to be bound by the constitution and rules of EC and any additional rules imposed by the competition.

NOTE: Any horse entered in any class at these competitions may be selected for equine medication control testing while at the event location.

---

## RULES AND REGULATIONS

---

We respectfully ask that you observe the following considerations while on Blue Star property to ensure the safety, well-being and enjoyment of all spectators and competitors:

**Person Responsible** The Person Responsible (PR) for a horse must be an adult who has, or shares responsibility for the care, training, custody and performance of the horse and who has official responsibility for that horse under EC rules. The PR is liable under the penalty provisions of the applicable EC rules for any rule violations. Every entry form for an EC sanctioned competition must identify the PR and be signed by the PR. PR must be an EC Sport License holder in good standing OR in the case of a junior/minor owner entries, a parent/guardians entitled to sign.

- 1) All riders and owners must be current members of the OEF and EC (Bronze level membership). PLEASE PROVIDE COPIES WITH YOUR ENTRY.
- 2) All entries must be paid before the start of the class. Open cheques are welcome and recommended. We will calculate and balance invoices when closing entries. A receipt will be provided on closing. A \$40 charge will be applied on all NSF cheques received.
- 3) All competitors and non-showing horses must register and display a number at all times whilst at the venue.
- 4) If scratching from a class, please ensure that the show office knows and that you give us at least one class notice. A refund less the administrative fee will only be provided upon receipt of a veterinary certificate and at the discretion of the Show Manager.
- 5) It is understood that ALL riders must wear an ASTM/SEI or BSI/BS EN approved helmet. If a rider does not meet this requirement, he/she will not be allowed to compete at these competitions. See Rules of Equine Canada A905 Headgear.
- 6) All trainers, coaches etc., must sign a BSF waiver of responsibility before mounting any horse for any reason unless they are registered as a competitor. Please check in with the Show Office if the need arises.
- 8) Any horse entered in any class at these competitions may be selected for equine medication control testing while at the event location.
- 9) All dogs and children must be under control at all times. The poop-and-scoop rule is in effect. Dogs must be leashed at all times. Under no circumstances should dogs be left unattended in your vehicle at any time.
- 10) Water and washrooms are provided for your convenience. Please help us keep these areas clean.
- 11) Parking areas have been designated on the attached facilities map. Limited car and handicapped parking is available by the arena. Trailer turn-around for stabling drop off only in this area. All Trailer parking is located behind the show facilities and accessed through the farm entrance. **SPEED 10 mph. Please use caution as horse and riders will be sharing this access area.**
- 12) Blue Star Farm owners, management and volunteers are in no way responsible for any loss, damage or injury to animals, property or persons. Competitors and spectators are on the property at their own risk. Please do not leave unattended vehicles unlocked.
- 13) If you have any suggestions to the improvement of our show, please direct them to show management only. We welcome your constructive comments.

**The BSF 2017 Shows:  
Calendar also includes ...**

Bronze Dressage –	May 28 <sup>th</sup> , July 2 <sup>nd</sup> and Sept 10 <sup>th</sup>
Combined Training –	May 14 <sup>th</sup>

## LIMITED STABLING IS AVAILABLE

Day Stall	\$60.00	per show day
Overnight Stall	\$75.00	per 24 hour period
Tack Stall	\$60.00	per show day <i>(availability to be confirmed)</i>
Hay / Shavings	\$ 7.00	per bale

Limited stabling is available on the day of the show on a first reserved basis and should be booked in advance. We will not accept stable requests unless accompanied by an Entry Form. All "Day" stalls must be vacated by end of show day. If a cancellation is received, every effort will be made to resell the stall. A refund will only be made available if we are able to resell the stall. Please ensure to bring your own buckets.

DAY STALLS MUST BE VACATED BY 8:00 PM DAY OF SHOW OTHERWISE THE OVERNIGHT FEE WILL BE CHARGED.

A list of stall assignments will be posted on our website. Please ensure that you check our website at [www.bluestarfarm.com](http://www.bluestarfarm.com).

## ON-SITE SHOW FACILITIES AT BLUE STAR FARM

Owned and operated by  
**MIKE & SHIRLEY  
HETHERINGTON**

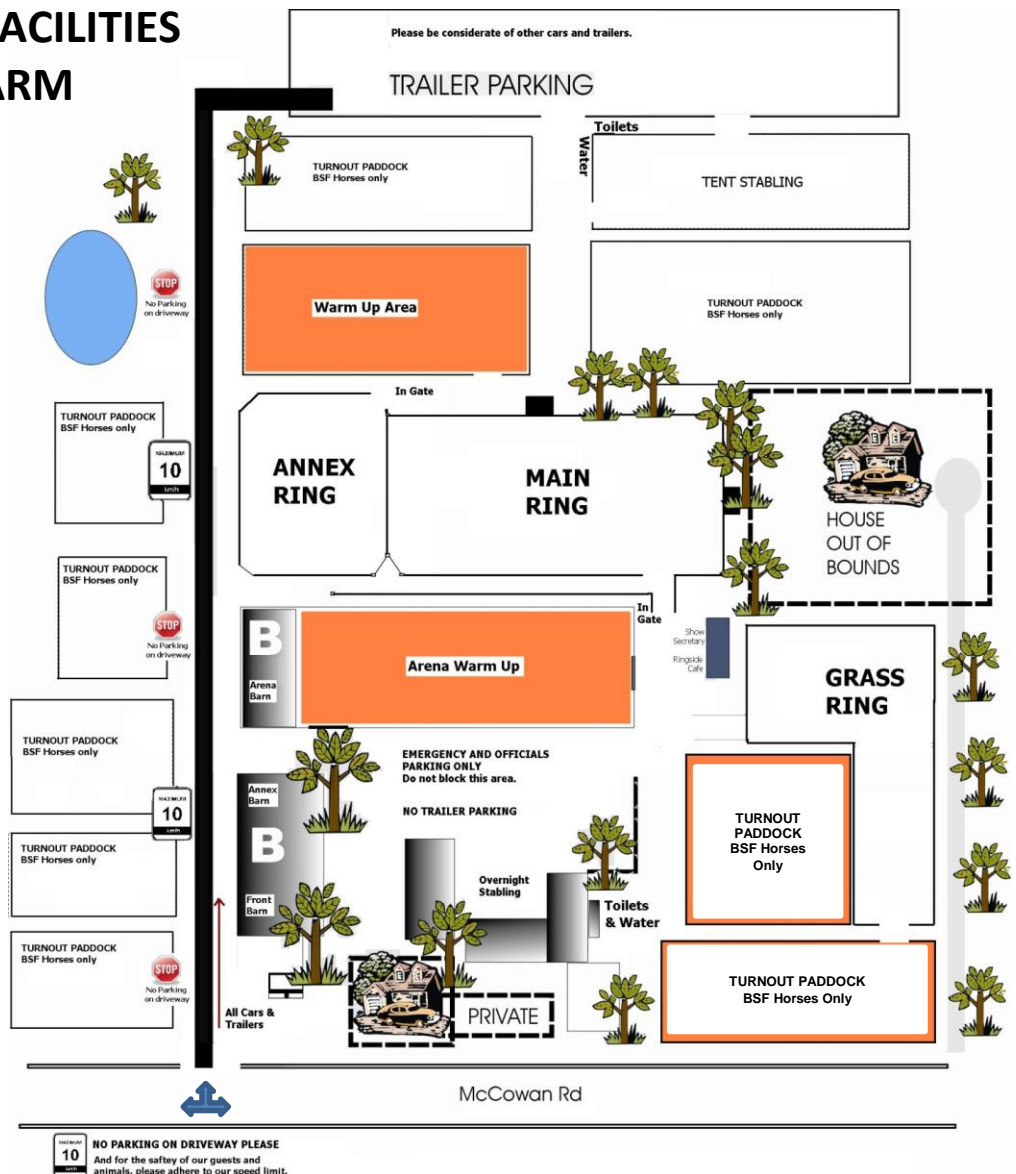

**NO PARKING ON DRIVEWAY PLEASE**  
And for the safety of our guests and animals, please adhere to our speed limit.

For further information please contact –

Shirley Hetherington  
BLUE STAR FARM  
19138 McCowan Rd  
Mt. Albert, Ontario  
LOG IMO



**BLUE STAR**

Phone (905) 473-6045  
Toll Free Fax 1-866-551-5381 or (905) 473 -5772  
Email [bluestarfarm@sympatico.ca](mailto:bluestarfarm@sympatico.ca)  
Web Site [www.bluestarfarm.com](http://www.bluestarfarm.com)

BLUE STAR FARM is located on the northwest corner of Mt Albert Rd and McCowan Rd, 1 concession west of Hwy #48.

