

# BLUE STAR FARM

Boarding, Training and Horse Show Facility  
Hunters / Jumpers / Dressage



## 2017 DRESSAGE

### Bronze Series Competitions

#### Officials:

#### May 21<sup>st</sup>

Judges – Peta Christen and Jackie Bellamy-Zions  
Steward – Anne Welch  
Closing Date – May 15<sup>th</sup>

Show Manager – Shirley Hetherington  
Secretary – Sandra Keene  
Announcer – Paul Hillier

#### July 16<sup>th</sup>

Judges – Camilla Giffen and Nancy Carter  
Closing Date – July 10<sup>th</sup>  
Steward – Anne Welch

#### Office Staff

Cameron Edwards  
Sarah Tackaberry

#### August 13<sup>th</sup>

Judges – Peta Christen and Rene Huyge  
Closing Date – August 7<sup>th</sup>  
Steward – Anne Welch

#### Ring Staff

Whipper-In - Ann Nicholls  
Scribes – Amy Bostock, Leslie Milne, Linda Weldon

#### Emergency Staff

Medic - Lana Hart  
Veterinarian – Michael Zajac (on call)  
Farrier – Barney Cummings Group (on call)

**Show Office Open 7:00 am**

**First Class at 8:00 am**

---

## DIVISIONS & CLASS LIST

---

Every class offered herein is covered by the Rules and Specifications of the current rules of EC – [www.equestrian.ca](http://www.equestrian.ca) and will be held and judged in accordance with said rulebook. All tests are the EC 2017 Tests with the exception of

Walk/ Trot tests C and D which are Dressage Canada 2015 and can be viewed at <http://equestrian.ca/dressage>.

Competitors must have current memberships with both EC (Bronze Level) and the Ontario Equestrian Federation. Please provide photocopies of BOTH Cards with entry.

**Person Responsible** The Person Responsible (PR) for a horse must be an adult who has, or shares responsibility for the care, training, custody and performance of the horse and who has official responsibility for that horse under EC rules. The PR is liable under the penalty provisions of the applicable EC rules for any rule violations. Every entry form for an EC sanctioned competition must identify the PR and be signed by the PR. PR must be an EC Sport License holder in good standing OR in the case of a junior/minor owner entries, a parent/guardians entitled to sign.

Entries for each division may be limited. Ring Size for all tests will be set at 20m x 60m

Walk/Trot	Equine Canada 2015 Tests C	Open
	Equine Canada 2015 Tests D	Open
Training Level	Tests 1, 2 and 3	Open/AA/Jr
First Level	Tests 1, 2 and 3	Open/AA/Jr
First Level Freestyle		Open
Second Level	Tests 1, 2 and 3	Open/AA/Jr
Second Level Freestyle		Open
Third Level	Tests 1, 2 and 3	Open/AA/Jr
Third Level Freestyle		Open
Fourth Level	Tests 1, 2 and 3	Open/AA/Jr
Fourth Level Freestyle		Open

Please note: If entries are small i.e. less than 5, classes may be combined and run as Open. However, year-end points will be assigned to the entered divisions i.e. AA, JR or AA

**Hors Concours Entries.** If you wish to try any test that is not offered above, please let us know and we will accommodate the request as an Hors Concours entry – see fees below.

Hors Concours are NOT eligible for ribbons or awards but will be scored.

---

## ENTRY FEES

---

Walk/Trot, Training Levels	\$35.00
First and Second Levels	\$40.00
Third and Fourth Levels	\$45.00
Freestyles	\$45.00
Hors Concours (regardless of level)	\$45.00
Administration Fee (includes medic fee)	\$30.00
Dressage Canada Levy	\$ 10.00
Drug Fee (Bronze competitor)	\$ 3.50
Late Fee *	\$10.00

HST (13%) will be collected on all entries with the exception of the DC Levy.

Registration # R124935214

**Cancellations** accompanied by a vet certificate or Doctor's note will be accepted with a full refund less administration fee post-closing date and pre-show date. **Cancellations** on show day for any reason and no shows will be charged the full amount.

Substitutions will be permitted in cases of lame horses or injured riders. In the case of riders, they should have the same status as the entered rider i.e. AA, JR or Open

When necessary, large classes will be split after 20 entries.

\* **Late Fee** – If entries are faxed after the closing date or are sent without payment and if a cheque is not received before competition day, a \$10 late fee will be charged.

Blue Star Farm is not permitted to accept any entry from an EC member not in good standing as per EC rule A805-1

---

## OFFICIAL EQUESTRIAN CANADA STATEMENT OF PRINCIPLES

---



### Statement of Principles

Equestrian Canada (EC), the national equestrian federation of Canada, supports adherence to the humane treatment of horses in all activities under its jurisdiction.

All Persons shall be committed to:

- upholding the welfare of all horses, regardless of value, as a primary consideration in all activities;
- requiring that horses be treated with kindness, respect and compassion, and that they never be subjected to mistreatment;
- ensuring that all Equestrians including owners, trainers and competitors, or their respective agents, use responsible care in the handling, treatment and transportation of their own horses as well as horses placed in their care for any purpose;
- providing for the continuous well-being of horses by encouraging routine inspection and consultation with health care professionals and competition officials to achieve the highest possible standards of nutrition, health, comfort and safety as a matter of standard operating procedure;
- providing current information on Code of Practice for the Care and Handling of Equines and other equine health and welfare initiatives;
- continuing to support scientific studies on equine health and welfare;
- requiring owners, trainers and competitors to know and follow their sanctioning organization's rules, and to work within industry regulations in all equestrian competitions; and
- actively promoting the development of and adherence to competition rules and regulations that protect the welfare of the horse.

The standard by which conduct or treatment will be measured is that which a person who is informed and experienced in generally accepted equine training and competition procedures would determine to be neither cruel, abusive, nor inhumane.

**Per Article A801**, every entry at an EC sanctioned competition shall constitute an agreement by the person responsible that the owner, lessee, trainer, manager, agent, coach, driver or rider and horse shall be subject to the EC constitution and all rules of EC and any additional rules set by the competition. It is the responsibility of all individuals participating in any capacity in EC sanctioned competitions to be knowledgeable regarding the EC constitution and the applicable rules of EC and the additional rules, if any, imposed by the competition. Do not participate in this EC sanctioned competition in any capacity if you do not consent to be bound by the constitution and rules of EC and any additional rules imposed by the competition.

Any horse entered in any class at these competitions may be selected for equine medication control testing while at the event location.

---

## STABLING

---

<b>FEES</b>	Day Stall	\$60.00	per show day
	Overnight Stall	\$75.00	per 24 hour period
	Tack Stall	\$60.00	per show day ( <i>availability to be confirmed</i> )
	Hay / Shavings	\$ 7.00	per bale

Limited stabling is available on the day of the show on a first reserved basis and should be booked in advance. We will not accept stable requests unless accompanied by an Entry Form. "Day" stalls must be vacated by end of show day. If a cancellation is received, every effort will be made to resell the stall. A refund will only be made available if we are able to resell the stall.

Please ensure to bring your own buckets.

DAY STALLS MUST BE VACATED BY 8:00 PM DAY OF SHOW OTHERWISE THE OVERNIGHT FEE WILL BE CHARGED.

A list of stall assignments will be posted on our website. Please ensure that you check our website at [www.bluestarfarm.com](http://www.bluestarfarm.com).

---

## PRIZE MONEY / DAY CHAMPIONSHIPS

---

Ribbons will be awarded from 1<sup>st</sup> to 6<sup>th</sup>. (Note regulation 3.13.j: one horse in class)  
Prize money will be offered to classes with six (6) or more entries as follows:

**1<sup>st</sup> - \$50      2<sup>nd</sup> - \$30      3<sup>rd</sup> - \$20**

---

## SHOW and YEAR END CHAMPIONSHIPS

---

Each show will offer Division Champion and Reserve Champion ribbons for those Divisions who have three riders with qualifying scores. Two classes in each division must be ridden to qualify for Day and Year End Championship awards. Freestyle tests will not be included in Division award tabulations. Horse/Riders best two scores of the day will be averaged to identify Division and Reserve Champion.

High Point Ribbon will be announced on our website under show results and the ribbon will awarded on the next show date. Freestyle scores are not eligible.

The year-end awards are offered for the most points gained over the three shows. To qualify, all three shows must be attended. Ribbons and prizes will be offered to the Year End Champions and Reserve Champions of each division. AA, JR and Open

## RIDE TIMES

Confirmation of riding times will be posted on our website the Thursday before the show date.

[www.bluestarfarm.com](http://www.bluestarfarm.com)

Telephone confirmations are available on the Thursday prior to show dates during the day.  
Please call (905) 473-6045.

Please let us know on your entry form if you are traveling with another competitor, riding multiple horses, coming with a trainer with other competitors or if you need extra time for traveling distance so we can better organize your riding times. We will try our best to accommodate "special" needs if possible.

---

## WHILE AT BLUE STAR FARM ...

---

**We respectfully ask that you observe the following considerations while on our property to ensure the safety, well-being and enjoyment of all spectators and competitors –**

- As per ARTICLE E 4.0 SAFETY HEADGEAR, all athletes, regardless of age or level of competition, must wear properly fitted and fastened safety approved protective headgear at all times when mounted at any EC sanctioned Dressage competition at the event location. (See Glossary – Headgear Standards)
- Non-showing horses must register and display a number at all times. All registered riders while mounted must also display competition numbers at all time while at the venue
- If you are scratching from a class, please ensure that the show office is advised as soon as possible.
- Please observe the "left-to-left" rule when passing in the arena.
- Please take home all that you've brought.
- All dogs and children must be under control at all times.
- Dogs must be leashed and the poop-and-scoop rule is in effect. It is not appropriate for any pet to be left in a vehicle unattended for any reason.
- Water and washrooms are provided for your convenience, so please keep these areas clean.
- Parking areas have been designated on the attached facilities map. All vehicles must park in the west field accessed from the main entrance and to the back of the farm. Please drive cautiously through the property. **Maximum speed is 10 mph on BSF Property.** Please use caution as horse and riders will be sharing this access area.
- Only officials and invalid parking is available in the central area by the arena.
- Blue Star Farm owners, management and volunteers are in no way responsible for any loss, damage or injury to animals, property or persons. Competitors and spectators are on the property at their own risk. Please do not leave unattended vehicles unlocked.
- If you have any comments or suggestions for the improvement of our show, please direct them to show management or the steward only.

**The BSF 2017 Shows:**

**Calendar also includes ...** Trilogy Combined Test: May 14<sup>th</sup>  
Bronze H/J: May 28<sup>th</sup>, July 2<sup>nd</sup> and Sept 10<sup>th</sup>



# ON-SITE SHOW FACILITIES AT BLUE STAR FARM

Blue Star Farm is owned and operated by  
**MIKE & SHIRLEY HETHERINGTON**

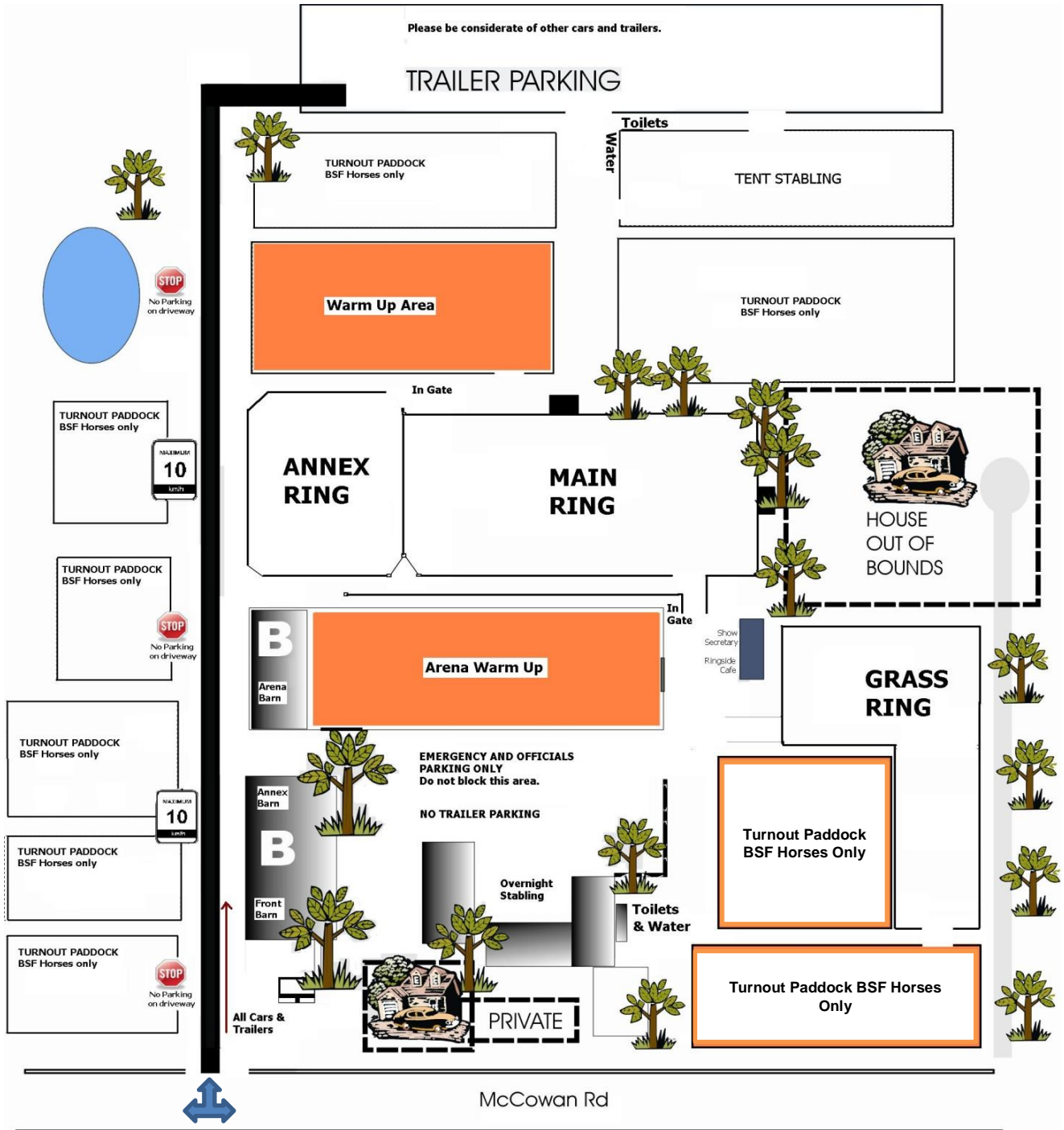

**NO PARKING ON DRIVEWAY PLEASE**  
And for the safety of our guests and animals, please adhere to our speed limit.

For further information please contact –



**Shirley Hetherington, Owner/Manager**

**BLUE STAR FARM**  
19138 McCowan Rd  
Mt. Albert, Ontario LOG IMO

Phone (905) 473-6045  
Fax (866) 551-5381 or (905) 473-5772 Email  
Email: [bluestarfarm@sympatico.ca](mailto:bluestarfarm@sympatico.ca)  
Web Site: [www.bluestarfarm.com](http://www.bluestarfarm.com)

BLUE STAR FARM is located on the N.W. corner of Mount Albert Road and McCowan Road in the village of Holt – 1 concession west of Hwy #48.

